

## Features

### XLC (XENO Lithium Ion Capacitor)

- Low Self Discharge
- High Operating Voltage
- Wide Operating Temperature Range
- High Capacitance



## Drawing

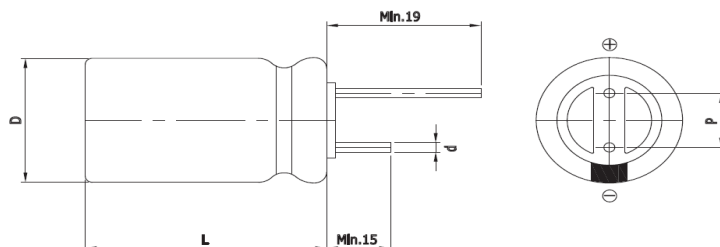

| Size   | 1030          |
|--------|---------------|
| D (Φ)  | 10.0 +1.0 Max |
| L (mm) | 30.0 ±1.5     |
| d (Φ)  | 0.8 ±0.1      |
| P (mm) | 5.0 ±0.5      |

## Specification

| Item                            | Spec. value  | Test methods   |
|---------------------------------|--|--|
| Operating Voltage Range         | 2.5V to 4.0V   |  |
| Operating Temp. Range           | -25 ~ 85°C (-40 ~ 85°C @ in Li/SOCL2 battery system)   |  |
| Load Life @ 85°C                | Capacitance : ± 30% of initial value<br>ESR : Less than 200% of initial spec.<br>Appearance : No abnormality | Temperature: 85±2°C<br>Time : 1,000 hours<br>Voltage : 4.0V<br>and measure the floating charge characteristics after returning to normal temperature and humidity. |
| Heat cycle characteristics      |  | Temperature: 85±2°C, -40±2°C<br>Duration: 30 min<br>Cycle Numbers: 100 cycles  |
| Cycle Life                      |  | Temperature : 25±2°C<br>Cycle Number : 50,000<br>Discharge Current : 20 C-rate<br>Cut-off Voltage : 2.5V (DOD 100%)  |
| Low Temperature characteristics |  | The specification shall be met lower category temperature range of -25°C   |

| Part Number | Rated Voltage (V) | Rated Capacitance (F) | ESR <sub>DC</sub> (mΩ) | ESR <sub>AC</sub> (mΩ) | Leakage Current (μA) | Self Discharge (V) | Rated Current (A) | Pulse Current (A) | Weight (g) |
|-------------|-------------------|-----------------------|------------------------|------------------------|----------------------|--------------------|-------------------|-------------------|------------|
| XLC-1030    | 4.0               | 100                   | 200                    | 100                    | 2                    | Over 97%           | 0.4               | 2.0               | 4.2±0.2    |
|             |                   | @ 25°C #1             | @ 25°C 100msec         | @ 25°C 1kHz            | @ 25°C 72hr          | @ 25°C #1          | @ 25°C            | @ 25°C #2         |            |

#1 Reference IEC62813 4.2  
 #2 1sec. Discharge to 3.2V